

CHECK VALVE zCHE



Body material	Nominal pressure	Nominal diameter	Max. temperature
A Grey cast iron	C 16 bar	DN 15-300	300°C
C Nodular cast iron	C 16 bar D 25 bar	DN 15-200	350°C
F Cast steel	E 40 bar	DN 15-200	450°C
I Cast stainless steel	E 40 bar	DN 15-200	400°C



correspond to the pressure equipment directive 2014/68/UE marking CE for DN≥32

**FEATURES**

- closing tightness class D acc. to EN -12266-1
- compact settlement
- environment-friendly
- no maintenance
- face-to-face dimension according to EN 558-1 series 1
- flanges drilled according to EN 1092-1 for type F, I
- flanges drilled according to EN 1092-2 for type A,C

**APPLICATION\***

\* not all of the applications are suitable for all of the executions  
 On the website [www.zetkama.com.pl](http://www.zetkama.com.pl) is a Chemical Resistance List, which specifies the parameters of work for a given medium.

industries						
	INDUSTRY	SHIPBUILDING INDUSTRY	HEATING	REFRIGERATION AND AIR CONDITIONING	CHEMICAL INDUSTRY	
media						
	GLYCOL	INDUSTRIAL WATER	DIATHERMIC OIL	STEAM	COMPRESSED AIR	NEUTRAL FLUIDS

Data given can be changed without notice.

Edition 06/2023

ZETKAMA Sp. z o.o.  
 Ul. 3 Maja 12  
 PL 57-410 Ścinawka Średnia

Tel. +48 74 8652 193  
 Tel. +48 74 8652 111  
 Fax +48 74 8652 199

E-mail [export@zetkama.com.pl](mailto:export@zetkama.com.pl)  
[www.zetkama.com](http://www.zetkama.com)

FIG.287

MATERIALS, DIMENSIONS

Type 38\* DN 15-150

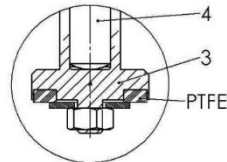
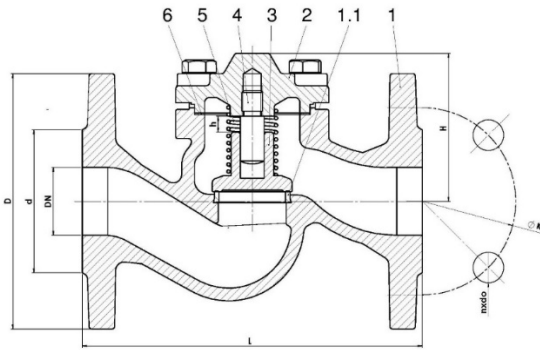

\* (max. temperature 200°C – on request)

	Body material	A		C	
		31; 41		33; 43	
1	Body	EN – GJL-250 5.1301 (ex. JL1040)	EN – GJS-400-18 5.1303 (ex. JS1025)	EN – GJL-250 5.1301 (ex. JL1040)	EN – GJS-400-18 5.1303 (ex. JS1025)
1.1	Seat ring	X20Cr13 1.4021		CuSn10	
2	Cover	EN – GJL-250 5.1301 (ex. JL1040)	EN – GJS-400-18 5.1303 (ex. JS1025)	EN – GJL-250 5.1301 (ex. JL1040)	EN – GJS-400-18 5.1303 (ex. JS1025)
3	Disc	X12Cr13 1.4021		CuSn10	
4	Stem	X12Cr13 1.4021		CuSn10	
5	Spring	X17CrNi16-2 1.4057		CuSn6	
6	Gasket	Graphite CrNi			
<b>Max. temperature</b>		<b>300°C</b>	<b>350°C</b>	<b>225°C</b>	

DN		15	20	25	32	40	50	65	80	100	125	150	200	250	300
L		130	150	160	180	200	230	290	310	350	400	480	600	730	850
PN16 EN – GJL-250 EN – GJS-400-18	D	95	105	115	140	150	165	185	200	220	250	285	340	405	460
	d	46	56	65	76	84	99	118	132	156	184	211	266	319	370
	K	65	75	85	100	110	125	145	160	180	210	240	295	355	410
	nxdo	4x14	4x14	4x14	4x19	4x19	4x19	4x19	8x19	8x19	8x19	8x23	12x23	12x28	12x28
PN25 EN – GJS-400-18	D	95	105	115	140	150	165	185	200	235	270	300	360	-	-
	d	46	56	65	76	84	99	118	132	156	184	211	274	-	-
	K	65	75	85	100	110	125	145	160	190	220	250	310	-	-
	nxdo	4x14	4x14	4x14	4x19	4x19	4x19	8x19	8x19	8x23	8x28	8x28	12x28	-	-
PN16, PN25 EN – GJL-250 EN – GJS-400-18	h	5	5	8	8	11	14	17	21	25	32	38	50	65	95
	H	56	56	67	76	89	96	104	124	161	174	197	248	295	315
	Kvs (m3/h)	5,6	7,8	12,8	19,8	28,4	46,6	77,5	108	169	263	366	592	1065	1553
	Weight (kg) A,C	2,4	2,8	4,0	5,5	7,4	9,5	13,6	19	27,4	45,1	66,2	111	196	302
Weight (kg) E		3,5	4,0	5,0	6,0	8,5	11	15	20	25	40	55	95	140	250

Data given can be changed without notice.

Edition 06/2023

FIG.287

**MATERIALS, DIMENSIONS**

Body material I DN 15-200

Body material F DN 15-200

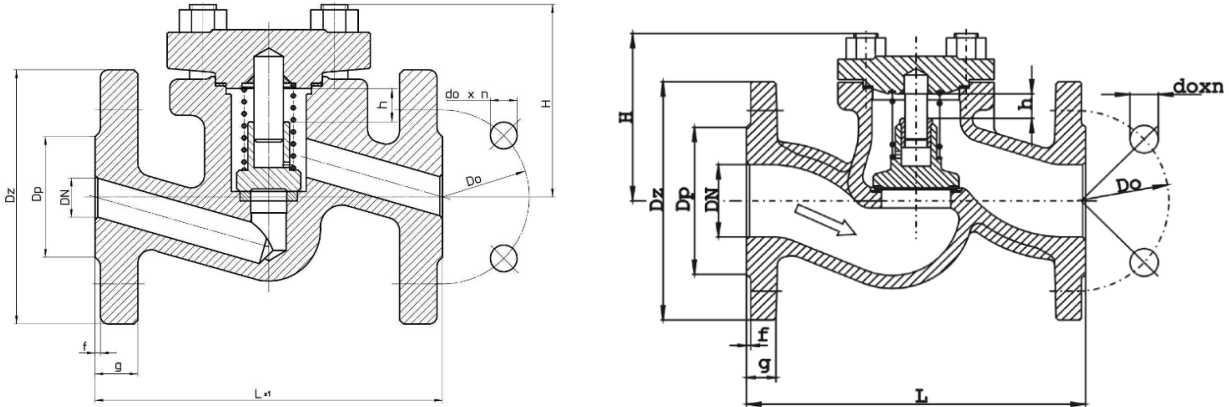

	Body material	F	I
	Type	31	31
1	Body	GP240GH	GX5CrNiMo19-11-2
2	Cover	P265GH	X6CrNiTi18-10
3	Disc	18-8 CrNi	18-8 CrNi
6	Gasket	Graphite	
Max. temperature		450°C	400°C

Body material	I, F											
	DN 15	20	25	32	40	50	65	80	100	125	150	200
Dz (mm)	95	105	115	140	150	165	185	200	235	270	300	375
Dp (mm)	45	58	68	78	88	102	122	138	162	188	218	280
Do (mm)	65	75	85	100	110	125	145	160	190	220	250	320
f (mm)	2	2	2	2	2	2	2	2	2	2	2	2
g (mm)	16	18	18	18	18	20	22	24	24	26	28	34
doxn	14X4	14X4	14X4	18X4	18X4	18X4	18X8	18X8	22X8	26X8	26X8	30x12
L (mm)	130	150	160	180	200	230	290	310	350	400	480	600
H (mm)	56	56	80	105	112	122	150	170	195	198	220	268
h (mm)	7	7	8	8	10	10	16	20	25	31	38	50
Weight (kg)	3,0	3,8	4,3	9,1	10,4	12,6	20,0	31,0	41,0	54,0	76,0	150,0

Data given can be changed without notice.

Edition 06/2023

ZETKAMA Sp. z o.o.  
Ul. 3 Maja 12  
PL 57-410 Ścinawka Średnia

Tel. +48 74 8652 193  
Tel. +48 74 8652 111  
Fax +48 74 8652 199

E-mail export@zetskama.com.pl  
www.zetskama.com

**PRESSURE-TEMPERATURE RATINGS**

Acc. EN 1092-2	PN		-60°C ÷ <-10°C		-10°C ÷ 120°C	150°C	200°C	250°C	300°C	350°C	400°C	450°C
EN-GJL250	6	bar	-----		6	5,4	4,8	4,2	3,6	---	---	---
	16		-----		16	14,4	12,8	11,2	9,6	---	---	---
EN-GJS400-18 LT	16		-----		16	15,5	14,7	13,9	12,8	11,2	---	---
	25		-----		25	24,3	23	21,8	20	17,5	---	---
Acc. EN 1092-1			-20°C ÷ <-10°C	-10°C ÷ <50°C	50°C ÷ 100°C	150°C	200°C	250°C	300°C	350°C	400°C	450°C
GP240GH +N	40	bar	30	40	37,1	35,2	33,3	30,4	27,6	25,7	23,8	13,1
Acc. EN 1092-1			-60°C ÷ <-10°C		10°C ÷ 100°C	150°C	200°C	250°C	300°C	350°C	400°C	450°C
G-X5CrNiMo19-11-2	40	bar	40		40	36,3	33,7	31,8	29,7	28,5	27,4	---

Other type of valves on request.

Data given can be changed without notice.

Edition 06/2023

FIG.287



TYPE

Figure	Body material	Nominal diameter	Nominal pressure	Type
287	A Grey cast iron EN-GJL-250	15-300 mm	C 16 bar	31 loose disc with spring; stem, disc and seat ring - stainless steel
		15-150 mm	C 16 bar	38 loose disc with spring; stem, disc and seat ring - stainless steel; disc gasket PTFE (120°C)
		15-300 mm	C 16 bar	41 loose disc without spring; stem, disc and seat ring - stainless steel
		15-300 mm	C 16 bar	33 loose disc with spring; stem, disc and seat ring - bronze
		15-300 mm	C 16 bar	43 loose disc without spring; stem, disc and seat ring - bronze
287	C Nodular cast iron EN-GJS-400-18-LT	15-200 mm	C 16 bar	31 loose disc with spring; stem, disc and seat ring - stainless steel
		15-150 mm	C 16 bar	38 loose disc with spring; stem, disc and seat ring - stainless steel; disc gasket PTFE (120°C)
		15-200 mm	C 16 bar	41 loose disc without spring; stem, disc and seat ring - stainless steel
		15-200 mm	C 16 bar	33 loose disc with spring; stem, disc and seat ring - bronze
		15-200 mm	C 16 bar	43 loose disc without spring; stem, disc and seat ring - bronze
		15-200 mm	D 25 bar	31 loose disc with spring; stem, disc and seat ring - stainless steel
		15-150 mm	D 25 bar	38 loose disc with spring; stem, disc and seat ring - stainless steel; disc gasket PTFE (120°C)
		15-200 mm	D 25 bar	41 loose disc without spring; stem, disc and seat ring - stainless steel
		15-200 mm	D 25 bar	33 loose disc with spring; stem, disc and seat ring - bronze
287	F Cast steel GP240GH 1.0619	15-200 mm	E 40 bar	31 loose disc with spring; stem, disc and seat ring - stainless steel
287	I Cast stainless steel GX5CrNiMo19-11-2	15-200 mm	E 40 bar	31 loose disc with spring; stem, disc and seat ring - stainless steel

Data given can be changed without notice.

Edition 06/2023

ZETKAMA Sp. z o.o.  
Ul. 3 Maja 12  
PL 57-410 Ścinawka Średnia

Tel. +48 74 8652 193  
Tel. +48 74 8652 111  
Fax +48 74 8652 199

E-mail export@zetkama.com.pl  
www.zetkama.com

**FIG.287**



**ORDERING**

Figure	Body material	Nominal diameter	Nominal pressure	Type
287	A Grey cast iron EN-GJL-250	15-300 mm	C 16 bar	31 loose disc with spring; stem, disc and seat ring - stainless steel

**Order example acc. index**

**287 A 050 C 31**

Check valves, ends flanged, form straight  
 Grey cast iron EN-GJL-250  
 Nominal diameter(mm)  
 Nominal pressurePN 16  
 Loose disc with spring; stem, disc and seat ring - stainless steel

**287**  
**A**  
**050**  
**C**  
**31**

Data given can be changed without notice.

Edition 06/2023

ZETKAMA Sp. z o.o.  
 Ul. 3 Maja 12  
 PL 57-410 Ścinawka Średnia

Tel. +48 74 8652 193  
 Tel. +48 74 8652 111  
 Fax +48 74 8652 199

E-mail [export@zetkama.com.pl](mailto:export@zetkama.com.pl)  
[www.zetkama.com](http://www.zetkama.com)